

washroom
essentials



Product Features:

- High density polyethylene
- Surface mounted with concealed installation
- One handed opening and closing operation
- Easy to use and hygienic
- Parts: ICN-STRAP

Overall Dimensions:

Closed: 480mmW x 870mmH x 126mmD

Open: 480mmW x 458mmH x 885mmD

Construction:

OUTER CASE: Fabricated of high density polyethylene. Foldable design provides space optimisation. Designed for concealed installation, achieving the integration of the aesthetic effect with the wall.

BODY: Antibacterial high density polyethylene. With reinforced metal plate on the back making it firm, safe and reliable.

MOULDED LINER DISPENSER: For storage of disposable liners.

SAFETY BELT: With adjustable restraint to better protect baby when in use.

HANDLES: To hold clothes or carry bags to keep them off the floor.

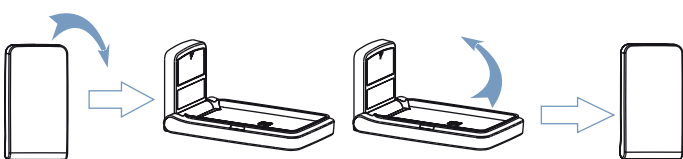

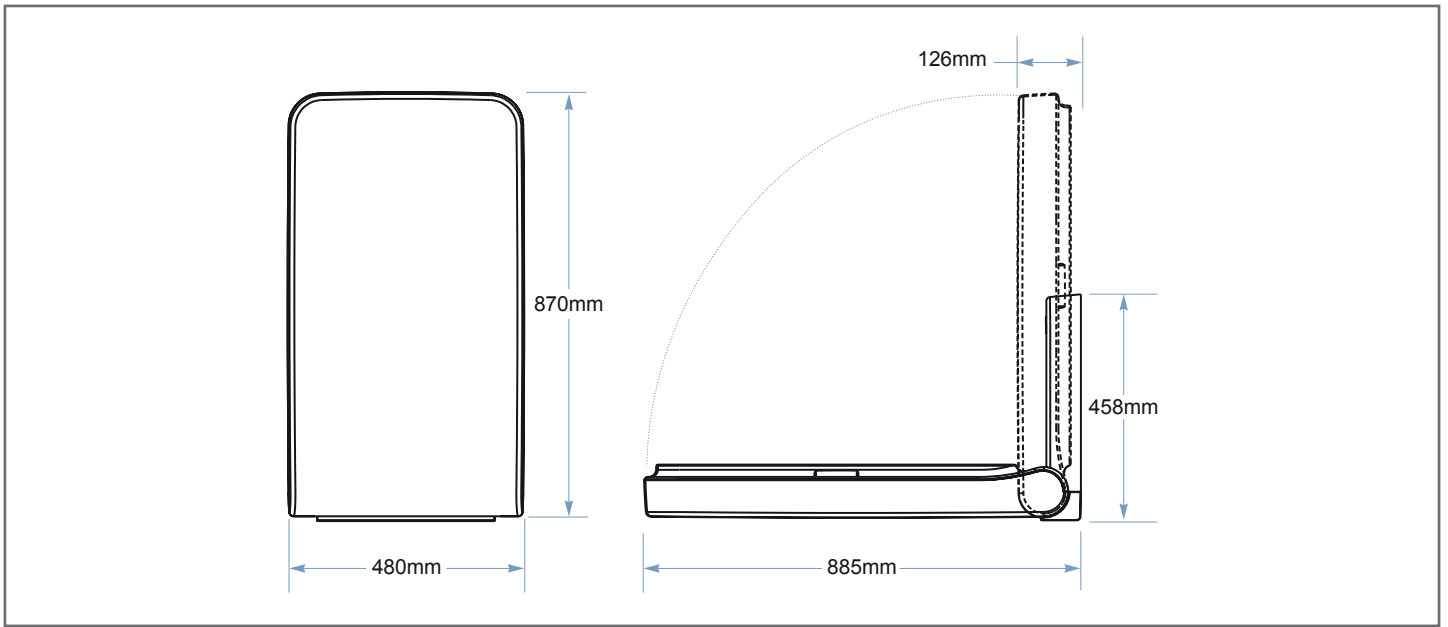

Operation:

Hinge system design, closing the table when not in use, allowing more efficient and rational use of space. Hinge bracket with metal design provides high strength and stability. The high quality gas spring design allows a one handed opening and closing operation. Designed for infants only up to 1 year and weighing less than 11kg.

Installation:

For complete installation instructions, see below

Method of Usage:

1. Unfold unit as shown on right
2. Take liner from paper holder and lay it on the table
3. Lay child in the centre of the changing table and clip together the ends of the restraint belt
4. After use, throw the liner into the trash and close the table.

Guide Specification:

Surface mounted unit shall be fabricated of antibacterial high density polyethylene with a reinforced metal back plate and with a sanitary disposable liner holder.

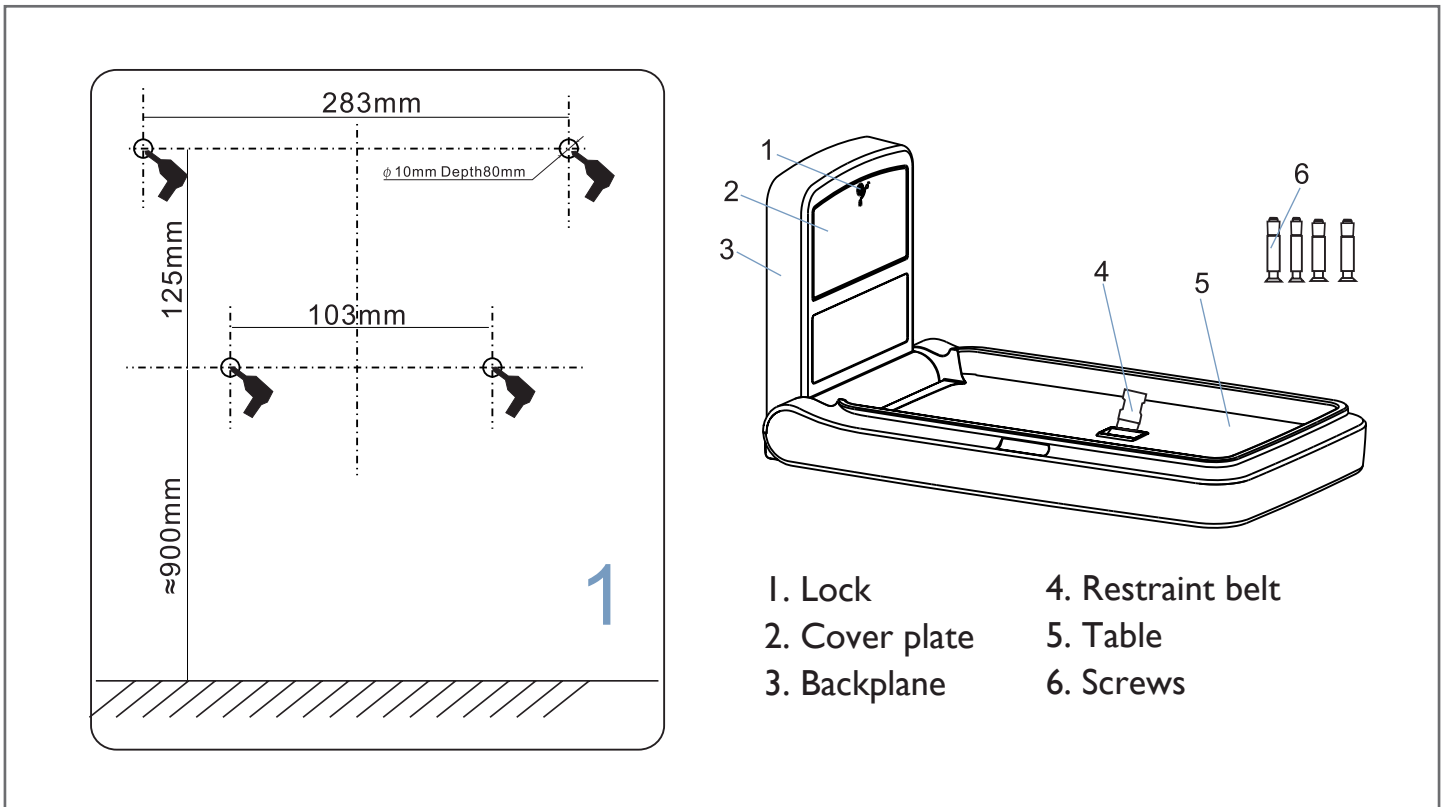

- | | |
|----------------|-------------------|
| 1. Lock | 4. Restraint belt |
| 2. Cover plate | 5. Table |
| 3. Backplane | 6. Screws |