

Installation manual of LED Mirror

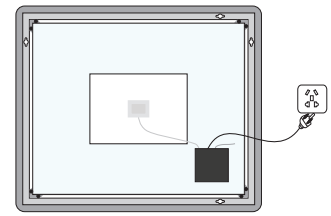
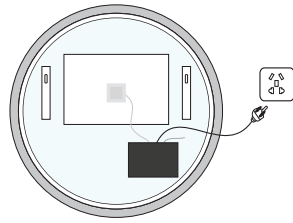
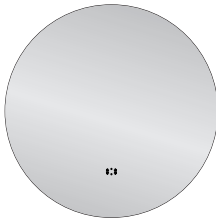

Three Lights: : Daylight - 6,000 K, cool white - 4,000 K, warm yellow light - 3,000 K
50-60 Hz with a 1m hardwire and plug output; Low-voltage 12v

An electrician will be required to provide in wall wiring and provision for an on/off switch before the bathroom walls are sheeted or tiled. When LED is selected cabinet size may vary slightly.

Warm white LED lighting is powered by a DC24V transformer, which comes with a 3-pin plug for connecting to an existing GPO or can be stripped off and hardwired in by your electrician.

As standard, your electrician should drop power down to the centre of your mirror in preparation for your new install.

Your electrician will need to provide on/off options when wiring in. An optional dimmer can also be purchased for light level adjustment.

1. Mark the positions of the two screw holes on the wall where you want to install the mirror according to the dimension given in the below sketch

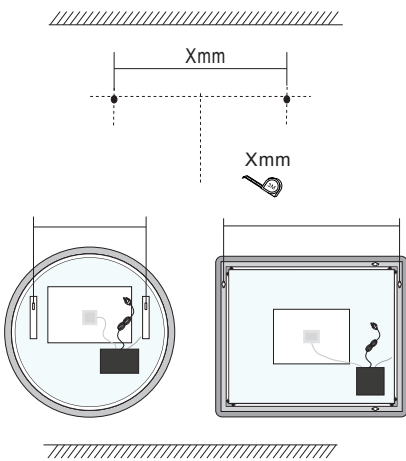

2. Drill holes previously marked, diameter and depth to be same as that of the screws

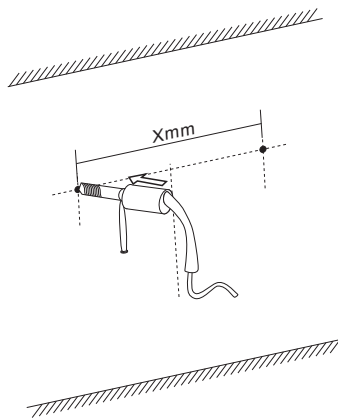

3. Insert the wall plugs into the drilled holes

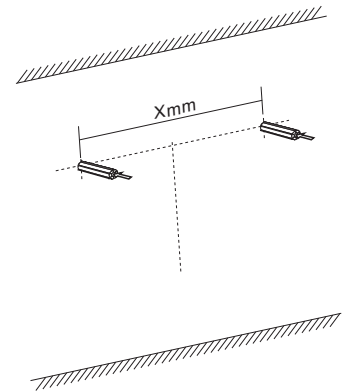

4. Spin into the drilling hole on the wall with the bent head screws in clockwise direction. (8mm appropriate exposed)

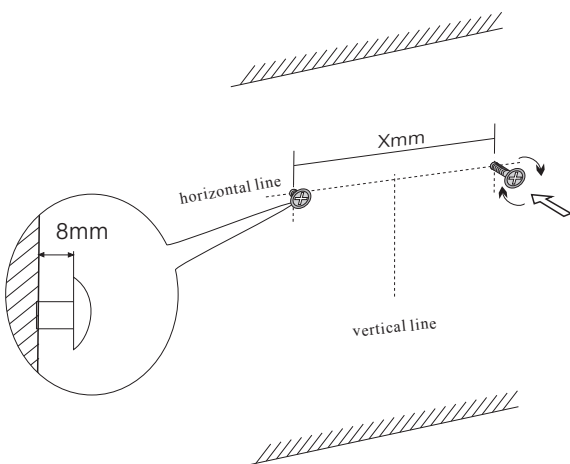

5. Place the mirror on the wall.

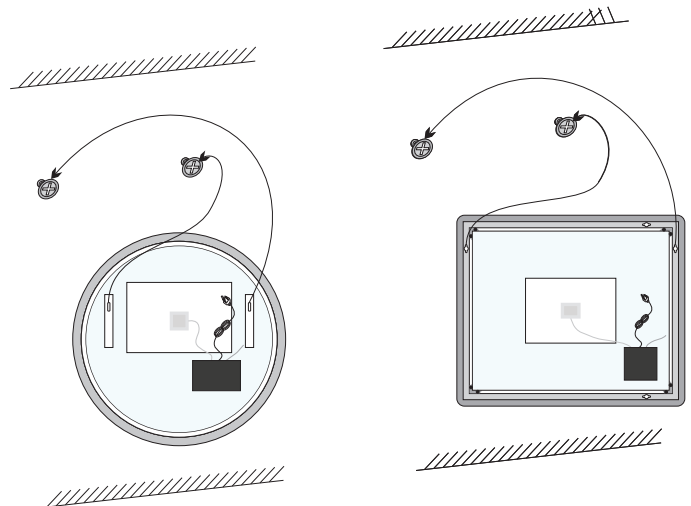

Package include(Round)



1X BATHROOM MIRROR



1 X MANUAL



2 X SCREWS



2 X WALL PLUG

Package include(Square)



1X BATHROOM MIRROR



1 X MANUAL



4 X SCREWS

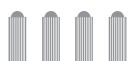

4 X WALL PLUG